



FB23

THE 23rd INTERNATIONAL CONFERENCE ON FEW-BODY PROBLEMS IN PHYSICS (FB23)

Sept. 22 -27, 2024 • Beijing, China

Host Institute of High Energy Physics, Chinese Academy of Sciences Institute for Advanced Study, Tsinghua University University of Chinese Academy of Sciences
China Center of Advanced Science and Technology Institute of Theoretical Physics, Chinese Academy of Sciences South China Normal University
Co-host Chinese Physical Society (CPS) High Energy Physics Branch of CPS

Arrival Guidance

Contents of FB23 Arrival Guidance

Dear FB23 attendees,

Thank you for supporting the 23rd International Conference on Few-Body Problems in Physics (FB23), which will be held in Beijing, China on September 22-27, 2024. This arrival guidance will make it easier for you to get to the venue and get help from others during your stay in Beijing, China. We are looking forward to meeting you in this September!

If you have other questions about FB23, please do not hesitate to contact us (FB23 Secretariat: fb23@ihep.ac.cn)

How to get to Wanda Realm Beijing	Page 3
Conference Venue Function Area Introduction	Page 6
Presentation Tips	Page 8
About Beijing	Page 9
Other Tips for Your Stay in China	Page 11

For more information, please refer to the official website <http://fb23.ihep.ac.cn/>

How to get to Wanda Realm Beijing

Conference Venue:

北京英协万达嘉华酒店 Wanda Realm Beijing

北京市石景山区石景山路甲18号院1号楼

Building 1, No. 18 Shijingshanlu, Shijingshan District, Beijing

Bus Station at walking distance:

老山公交站 Laoshan Bus Station

About 2 minutes walk, it can be reached by Bus No. 336, 337, 527, 546, 574, 914 and 941

京原东站 Jinyuandong Bus Station

About 10 minutes walk, it can be reached by Bus No. 527, 597, 598, 663, 914, 941, 959, 992 and 965

Subway Station at walking distance:

八宝山地铁站 Babaoshan Station

About 10 minutes walk to the conference venue

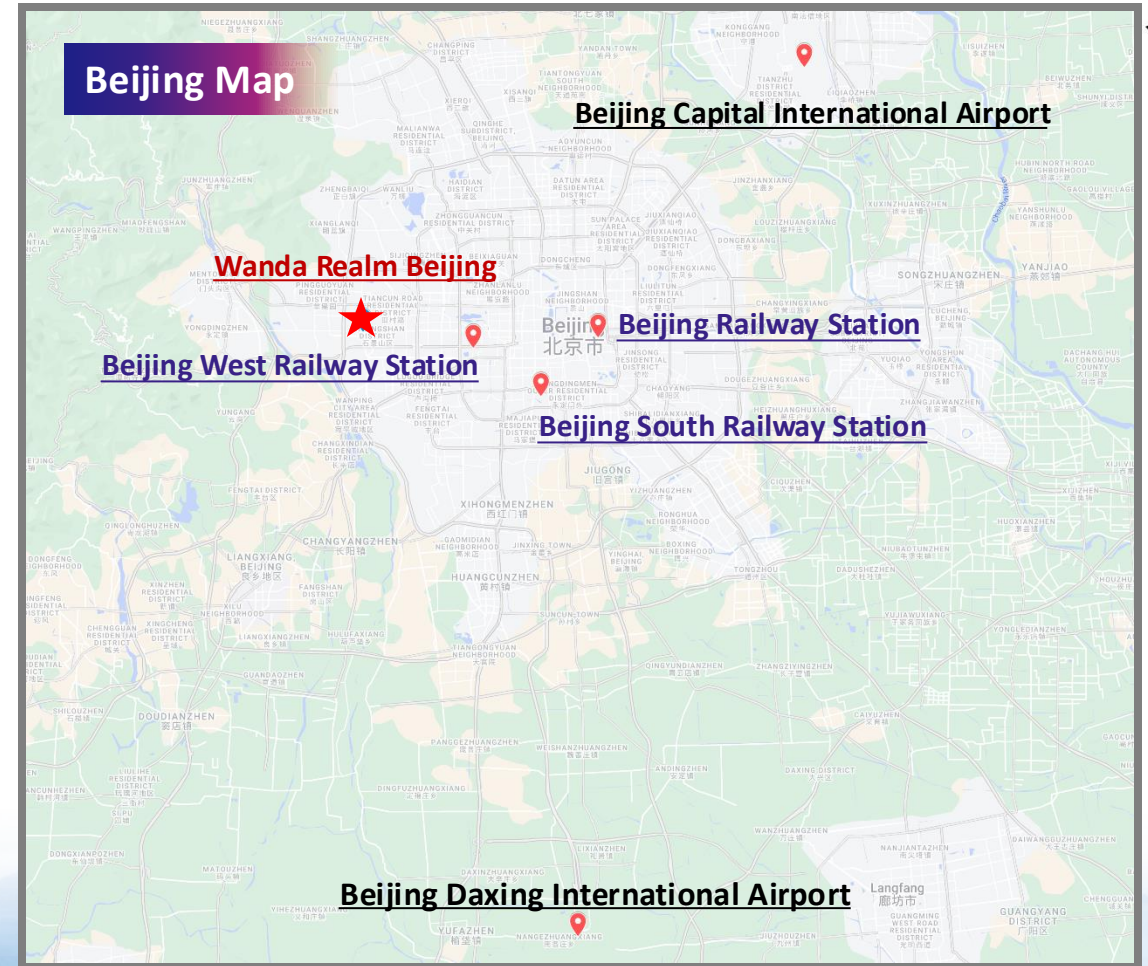

How to get to Wanda Realm Beijing

- From the Airport to the Venue

PEK - From Beijing Capital International Airport (50km)

1. Taxi (Highly Recommended) – about 1 hour drive

Taxi Locations: Please follow the signs in the terminal building

Fare: About **25 USD** in total, the cost differs according to the traffic conditions

2. Airport Shuttle Bus & Subway – about 2 hours

Take Airport Bus Line 2 Beijing South Station Line (South East Third Ring Road Direction)

→ transfer to Guomao (Dabeiyaonan) Public Bus Station to take Subway Line 1 (Gucheng Direction)

→ transfer to Babaoshan Station and get-off from Exit D

→ walk to the west, about 10 minutes' walk to the hotel

Airport shuttle bus ticket offices: Outside Gate 1-3 of Terminal 3

Fare: About **5 USD** in total

	Service Hour	Departure Interval
PEK Airport Bus Line 2	08:00-24:00	60 mins
Subway Line 1	05:00-24:00	5 mins

PKX - From Beijing Daxing International Airport (60km)

1. Taxi (Highly Recommended) – about 1 hour drive

Taxi Locations: Please follow the signs in the terminal building

Fare: About **30 USD** in total, the cost differs according to the traffic conditions

2. Subway – about 1.5-2 hours

Take Daxing Airport Subway Line (Caoqiao Direction)

→ transfer at Caoqiao Station to take Subway Line 10 (Jijiamiao Direction)

→ transfer at Gongzhufen Station to take Subway Line 1 (Gucheng Direction)

→ transfer at Babaoshan Station and get off from Exit D

→ walk to the west, about 10 mins walk to the hotel

Fare: About **8 USD** in total

	Service Hour	Departure Interval
Daxing Airport Subway Line	06:00-23:00	9 mins
Subway Line 10	04:37-22:30	5 mins

Tips for Transportation

- You may change money at the Banks or Money Exchange at the airport beforehand since you need Chinese money (RMB) to pay for the means of transportation.
- Kindly note that all the time is subject to traffic conditions.

How to get to Wanda Realm Beijing

- From the Railway Station to the Venue

There are three main railway stations in Beijing. They are Beijing Railway Station, Beijing South Railway Station, and Beijing West Railway Station. Please kindly refer to the transfer information below.





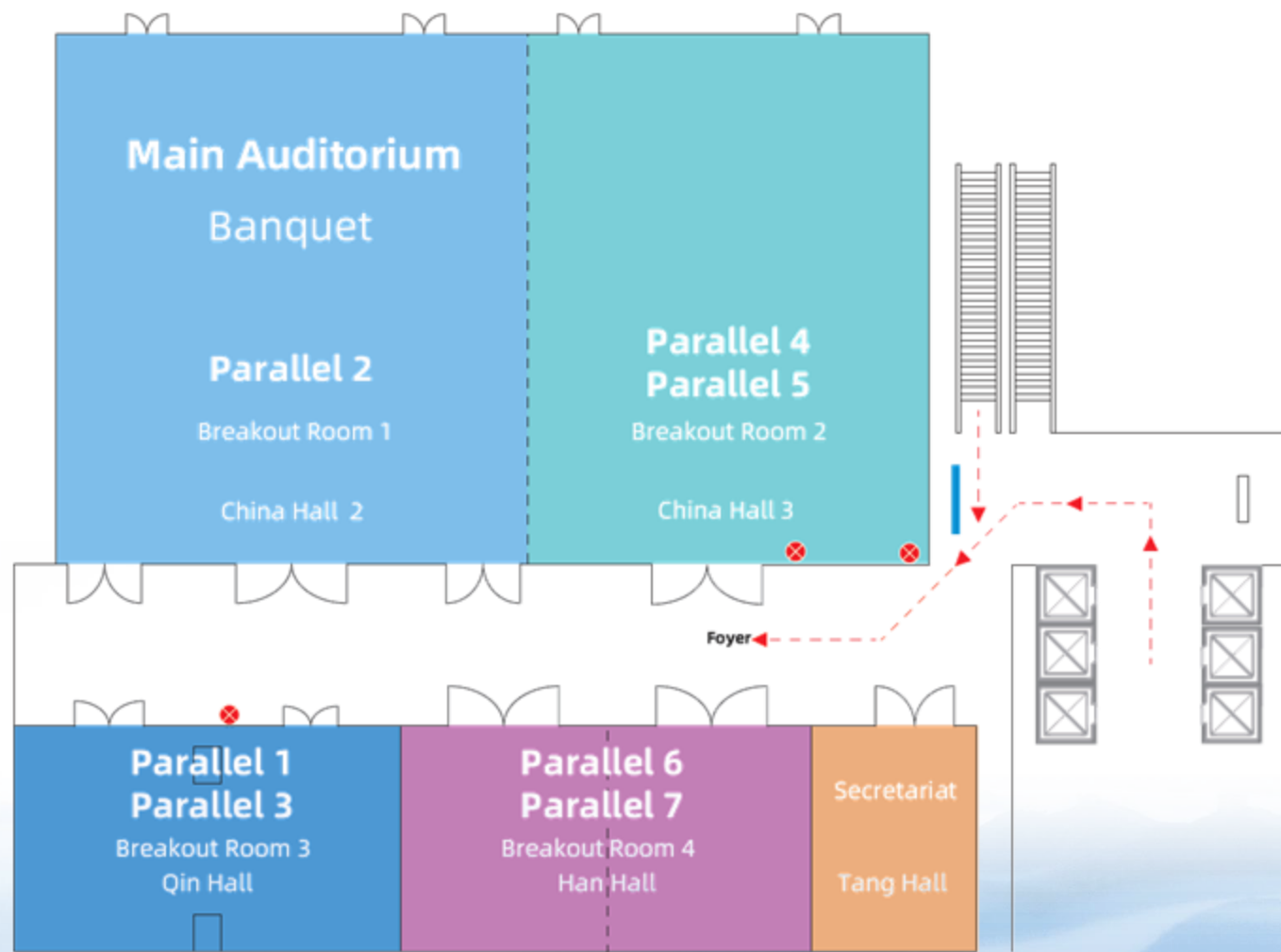

Railway Station	Dist.	Taxi (Highly Recommended)	Subway Fare about 1 USD
Beijing Railway Station	20km	About 40-50 mins drive Fare about 9 USD in total	About 60 mins Take Subway Line 2 (Jianguomen Direction) → transfer at Jianguomen Station to take Subway Line 1 (Gucheng Direction)
Beijing South Railway Station	20km	About 30-40 mins drive Fare about 10 USD in total	About 40-50 mins Take Subway Daxing Line-Line 4 (Anheqiaobei Direction) → transfer at Xidan Station to take Subway Line 1 (Gucheng Direction)
Beijing West Railway Station	12km	About 20 mins drive Fare about 6 USD in total	About 60 mins Take Subway Line 9 (Guojiatushuguan Direction) → transfer at Junshibowuguan Station to take Subway Line 1 (Gucheng Direction) → then → transfer at Babaoshan Station and get off from Exit D → walk to the west, about 10 mins walk to the hotel

	Service Hour	Departure Interval
Subway Line 1	05:00-24:00	5 mins
Subway Line 2	05:09-24:00	5 mins
Subway Line 4	05:05-24:00	5 mins
Subway Line 9	05:00-22:39	5 mins

Conference Venue Function Area



5F Floor Plan

-  **Main Auditorium & Parallel 2**
China Hall 2
-  **Parallel 4 & 5**
China Hall 1
-  **Banquet**
China Hall
-  **Parallel 1 & 3**
Qin Hall
-  **Parallel 6 & 7**
Han Hall
-  **Secretariat**
Tang Hall

Sign in, On-site Registration and Payment | Free Wi-Fi

Registration Desk

Date	Time	Location
Sep. 22	14:00-20:00	1F Lobby
Sep. 23	08:00-12:00	
Sep. 23	14:00-18:00	Secretariat At 5F Tang Hall
Sep. 24-27	08:00-18:00	

Windows introduction

Pre-registration			On-site Registration		Information
1	2	3	4	5	6

Pre-registration

People who have paid their registration fee sign in at these windows. Badges will be listed according to the first letter of attendees' family name, from A to Z.

Sample of the Badge

- Attendees' name, affiliation and nationality will be marked on the front.
- Information about registration desk, dining, free Wi-Fi and the electronic program could be quickly checked on the back.



On-site Registration

People who have registered but not paid yet and people who want to take part in the Conference but haven't registered the conference yet, please sign in at these windows.

For people have not register FB23 in the Indico systems, they need to fill in the on-site registration form first.

People could also pay their registration fee at this window, we accept **credit card payment, WeChat payment, and payment by Alipay.**

Information

If you have any problem or question when you sign in / register at 1-5 windows, or you need more information about FB23, the staff at the information window could help you.

Free Wi-Fi

Name: WandaHotels

Password:

- For domestic participants, there are two ways to get the codes
 - WeChat Authorized Login.
 - SMS verification code. The access code will be sent by SMS after you fill in your mobile phone number (for Chinese Mainland with +86 numbers only).
- For international participants, please come to the hotel's front desk, the staff there will issue a password for you.

Dining Information | Presentation Tips

Dining Information

FB23 attendees could get lunch coupons and Banquet tickets when they sign in at the registration desk. If you have any special diet requests, please let us know.

Lunch (Ticket Required)

- Date and Time: 12:30-14:00, September 23-27, 2024
- Location: 2F Beijing Ballroom

Reception (Ticket Required)

- Time: 18:10-21:00, Monday, September 23, 2024
- Location: 1F, Lobby Lounge
- Faddeev Medal Award Ceremony** will be held before the reception

Banquet (Ticket Required)

- Time: 19:30-21:30, Thursday, September 26, 2024
- Location: 5F, China Hall

Dining Tickets (could be get when you sign in at the registration desk)



Presentation Tips

Presentation Slides Uploading

During FB23, speakers should use the laptop in the meeting rooms to give the presentation. Volunteers will download your presentation slides from the Indico system a day before your session. Please upload your slides to Indico at least one day before the session. The program of the conference can be found in:

<https://indico.ihep.ac.cn/event/21083/timetable/#20240923>

Check Your PPT Slides before Your Session

To get a better performance for the meeting, we strongly recommended that speakers come to the meeting room at least half a day before their sessions to confirm the slides are in the latest version. During your testing, the staff of your meeting room will get the ratio of your slides and choose a better screen setting to match your slides.

If you have animation, video, music, or other multi-media documents in your slides, please let the staff know first.

Time for Oral Presentations

Speakers should check the time for oral presentations. The time includes about 5 minutes Q&A session. During the presentation, the chair of each session may inform the speaker when he or she has 5 minutes/3 minutes left by raising the time reminder

About Beijing (China)

Weather

September, praised as a golden month in Beijing, is cool, clear and brisk. Everywhere presents a harvest scene. The weather can still be hot in the afternoons during early September, but it is delightfully cool in the morning and evening. September is a good time to visit Beijing. The weather is comfortable and the fall scenery is very beautiful. The Traditional Chinese Mid-autumn Festival usually falls during the month, which adds a festive atmosphere to the city.

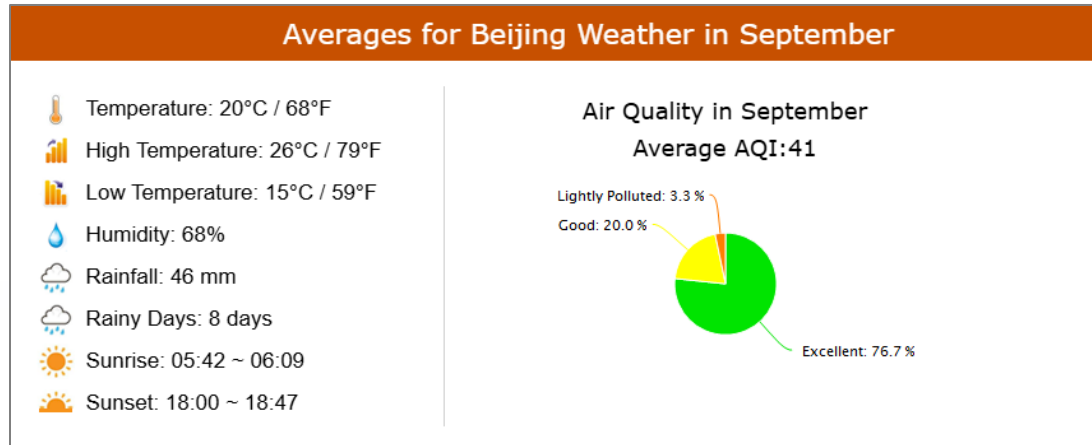

What to Wear in Beijing in September



Currency, Exchange, and Payment Methods In China

Chinese Currency

Renminbi (人民币) or RMB is the official currency of China, and it means “people’s currency” in Chinese. The basic unit of RMB is yuan (元), and the sign of yuan is ¥. CNY is the abbreviation of Chinese yuan, which is also been used widely to refer to Chinese currency.

Currency Exchange

After arriving in China, you can find many places to exchange Chinese currency, such as the exchange vendors in the major international airports, hotels, offices of local banks, and ATMs across the region. Exchanging major international cash, such as U.S. Dollars, Euros, Pounds, etc. into Chinese Yuan is not difficult in China. The exchange rates are regulated; however, the commission fees are varied from different banks, hotels, and airports.

Payment Methods in China

Credit and debit cards may not cover all your expenses in China. With the widespread popularity of digital payments, many businesses no longer offer point-of-sale (POS) systems for credit and debit card users. However, you can still use your bank cards via POS systems at selected hotels, shopping malls, and larger restaurants. Cash is still widely accepted. It is also very reliable. You’d better always bring some cash with you including some small changes.

Digital payment is the norm in China, with Alipay and WeChat Pay leading the way. Since July 2023, they’ve started accepting international cards through their apps, though success may vary depending on the user’s country and bank.

About Beijing (China)

Electricity

Voltage in China is 220V/50HZ. Hotels provide 220V and 110V (shavers only) power outlets. Please note that plug adapters and converters might be required.

Smoking

Smoking in indoor public places has been banned in Beijing since June 1, 2015, following the rolling out of the toughest-ever anti-smoking regulation in China. The regulation extends smoking bans to include all indoor public areas and workplaces, plus a number of outdoor areas including schools, seating areas in sports stadiums, and hospitals where women or children are treated.

Time

China covers five time zones. Beijing time (UTC + 08:00) is the only official time throughout the country; China Standard Time is 8 hours ahead of Greenwich Mean Time (GMT + 8). China does not operate Daylight-saving Time. Punctuality is highly appreciated.

For more information, please refer to the official website <http://fb23.ihep.ac.cn/>

[Click here to download the latest electronic FB23 Handbook](#)



The BEIJING PASS: Explore China with Ease

Beijing Pass, a multi-purpose card for international visitors, facilitating their payment for transportation, tourist sites and shopping centers. This card is issued for sale and can be recharged repeatedly.

With a maximum balance of 1,000 yuan (about 140.16 U.S. dollars), the Beijing Pass not only supports card payments for the Beijing Subway, suburban railways and taxis within Beijing, but also for public transportation in over 300 cities across China. Card holders can top up their Beijing Pass at 490 stations across 27 subway lines in Beijing through service counters or designated self-service machines. They can also add funds online via the "SilkPass" mobile application.

Moreover, international visitors can also use the card to purchase tickets for 30 popular tourist attractions in Beijing, such as the Summer Palace, the Temple of Heaven and the Badaling section of the Great Wall.



How to get the Beijing Pass ?

International visitors can purchase or refund the Beijing Pass at 15 locations in Beijing, including **Beijing Capital International Airport, Beijing Daxing International Airport** and **Beijing Railway Station**, with a valid ID.

Beijing metro enables 'tap-and-go' fare payment for foreign MasterCard, Visa card holders

Beijing has become the first city on the Chinese mainland supporting contactless fare payments in rail transit for foreign MasterCard and Visa card holders.

International visitors can use MasterCard and Visa cards issued overseas to take rides on the city's entire rail transit network, and pay automatically according to the same billing rules as the local residents.

The service is comprehensively available at all gates across 490 stations along 27 subway lines (including two airport lines, Xijiao Line and Yizhuang T1 Line), covering a total length of 836 km. Additionally, the Suburban Railway Line S2 is also part of this scheme.

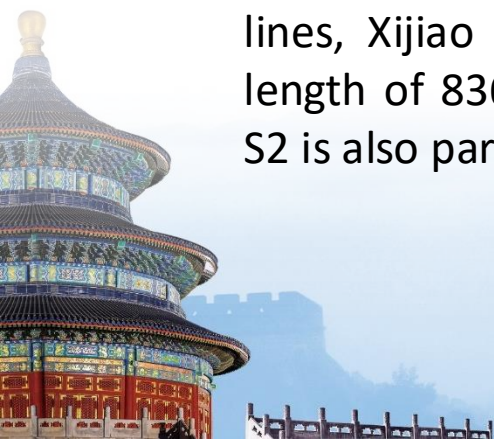

Tips: How to use AliPay in China

In China, people could pay for their daily cost by 5 payment methods: Bank card, mobile payment, cash, bank account and e-CNY.

Nowadays, digital payment is the most popular way. People just need to download the payment APPs and link their bank cards to it according to the steps, and then they could pay for the transfer, dinning, tickets and almost anything could be bought by a smart phone.

Follow the 2 steps shown in the right pictures, you could download the **Alipay** – one of the most popular APPs for mobile payment in China - and try to pay your cost during your stay in Beijing by Mobile.

两步用上支付宝 Get started with Alipay in 2 steps

1 下载和注册 Download and register

下载支付宝App, 点击【注册账号】, 选择【国际版】
Download Alipay App, tap "sign up" to register, choose international version

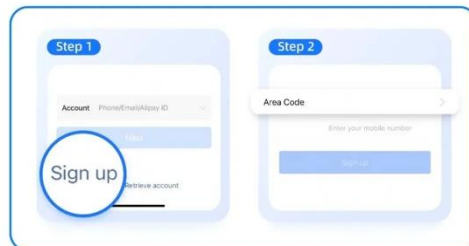
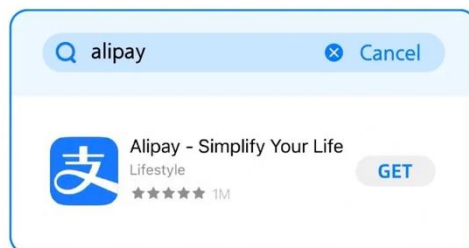

2 绑定银行卡 Add bank card

点击【立即添加】进入绑卡页面, 按照页面提示, 即可完成绑卡操作

Tap "Add now" and follow on-page prompts to complete the process

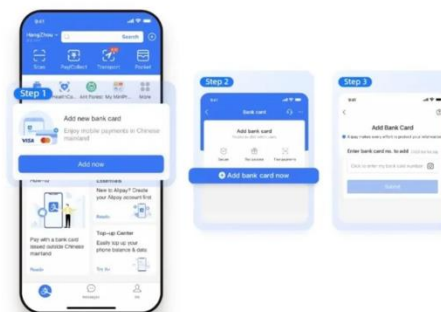

这些银行卡都支持
Eligible bank card types



去哪都能用支付宝 Pay with Alipay wherever you go

支付方法一 Option 1

点击【扫一扫】, 扫描商家的二维码
Tap "Scan", scan the merchant-presented QR code

支付方法二 Option 2

点击【收钱/付钱】, 出示你的二维码
Tap "Pay/Collect", present your QR code to the merchant

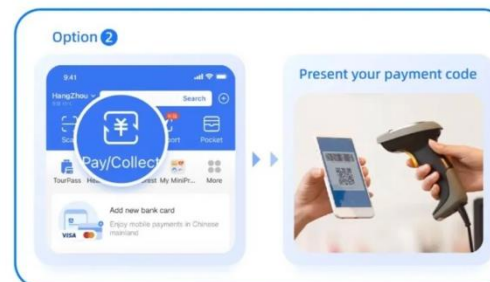
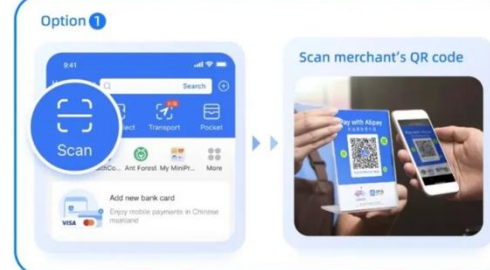



Thank you!

We are looking forward to seeing you soon.

FB23 Official Website: <http://fb23.ihep.ac.cn>

FB23 Secretariat: fb23@ihep.ac.cn